

How to Join Eduroam Wireless With iOS

Table of Contents

Complete Text Only Guide for Faculty/Staff.....	3
Complete Text Only Guide for Students.....	4
Picture Guide for Faculty/Staff.....	5 – 9
Picture Guide for Students.....	10 – 14

Complete Text Only Guide for Faculty/Staff

1. Tap "Settings."
2. Tap "Wi-Fi."
3. Tap "eduroam."
4. Enter as follows:
 - Username: YourUsername@lsus.edu
 - Password: YourPassword
5. Tap "Join."
6. Tap "Accept."

At this point the device should be on eduroam wireless.

Complete Text Only Guide for Students

1. Tap "Settings."
2. Tap "Wi-Fi."
3. Tap "eduroam."
4. Enter as follows:
 - Username: YourStudentID@lsus.edu
 - Password: YourPassword
5. Tap "Join."
6. Tap "Accept."

At this point the device should be on eduroam wireless.

Picture Guide for Faculty/Staff

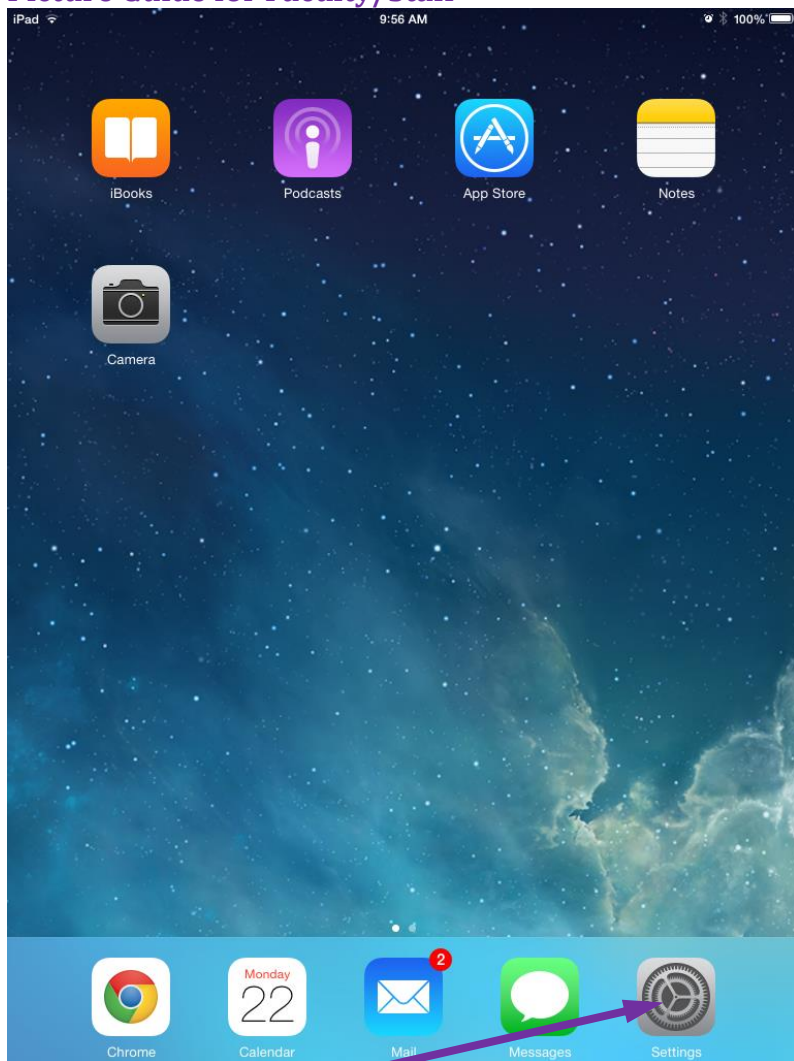

1. Tap "Settings."

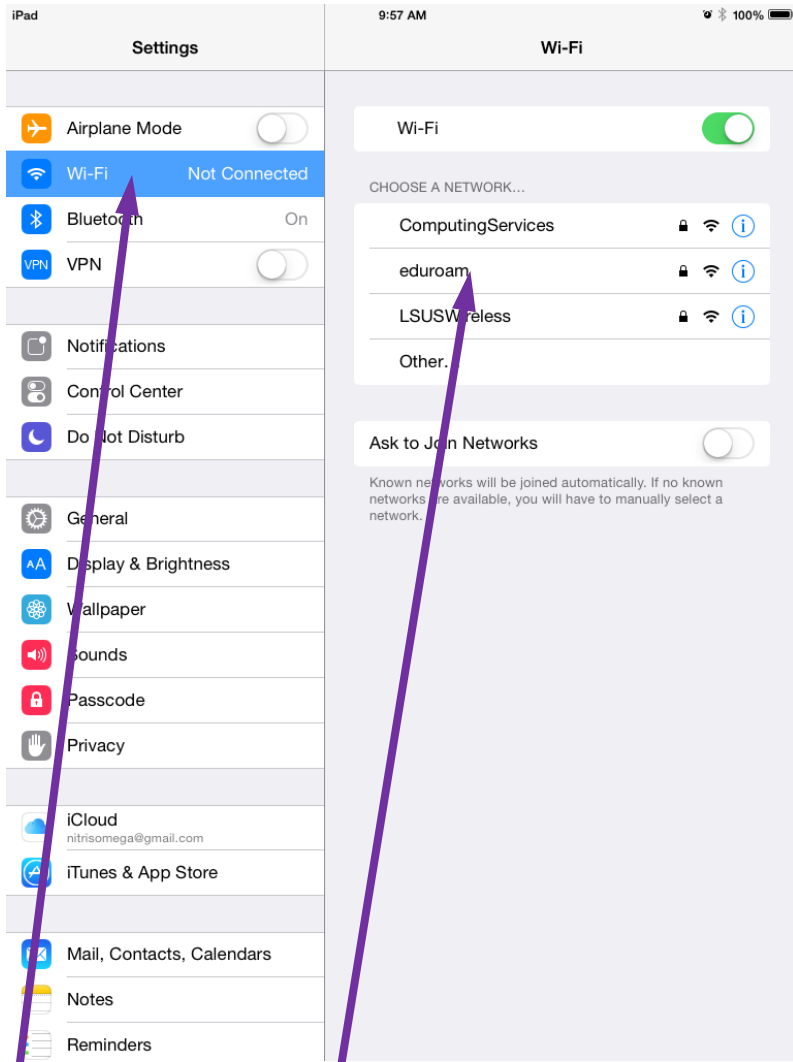

2. Tap "Wi-Fi."
3. Tap "eduroam."

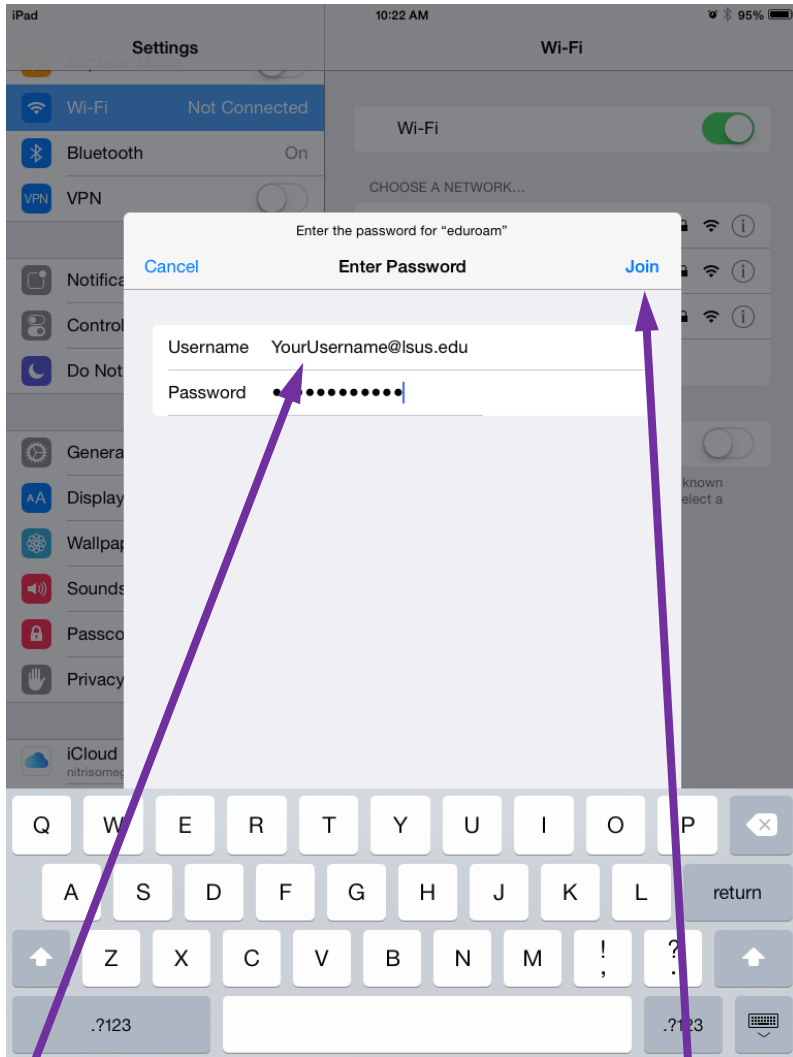

4. Enter your information as follows:
 - Username: YourUsername@lsus.edu
 - Password: YourPassword
5. Tap "Join."

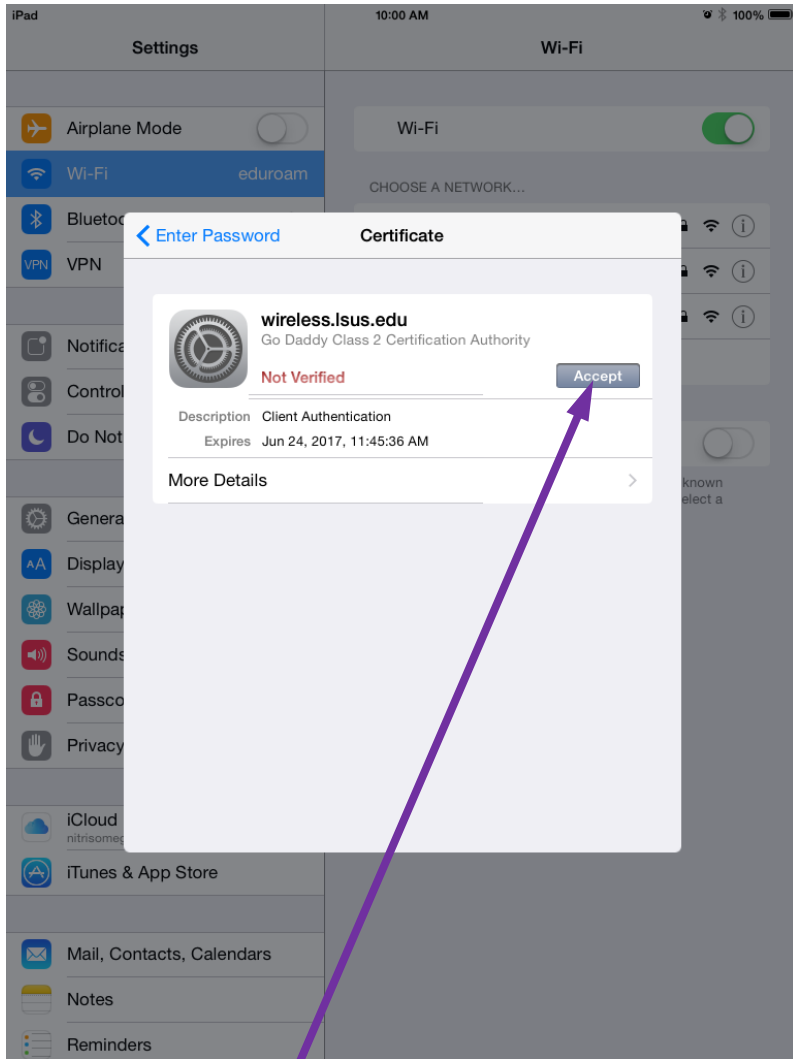

6. Tap "Accept."



At this point the device should be on eduroam wireless.

Picture Guide for Students

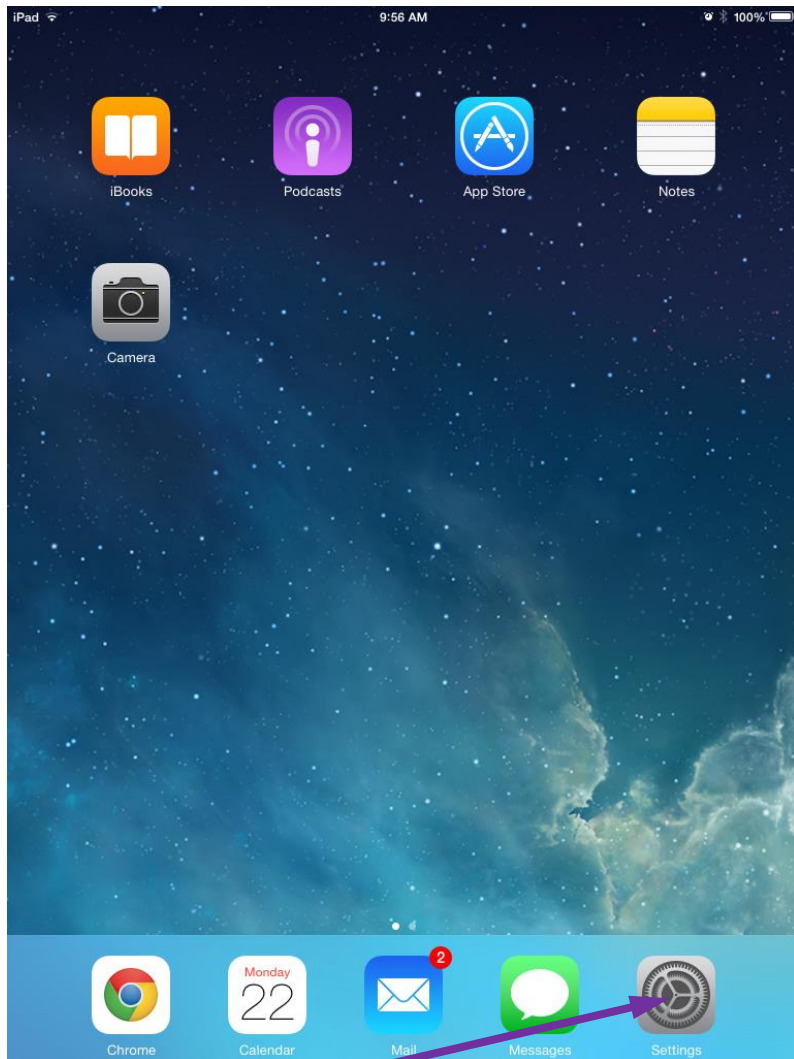

1. Tap "Settings."

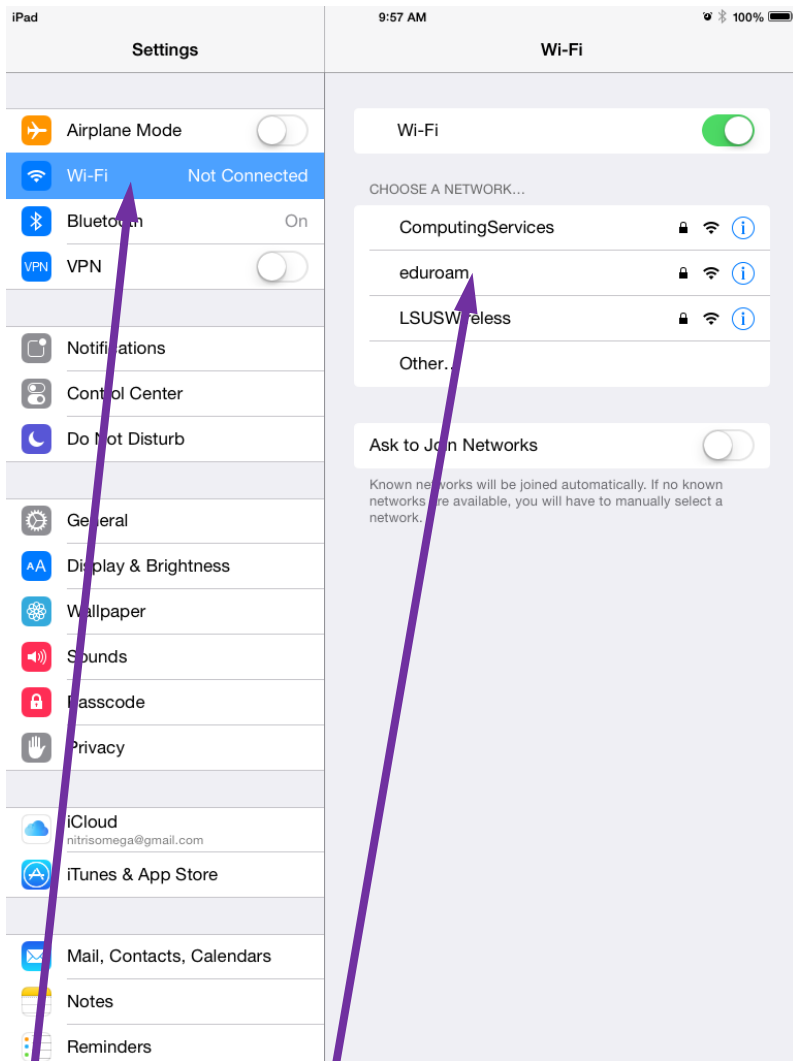

2. Tap "Wi-Fi."
3. Tap "eduroam."

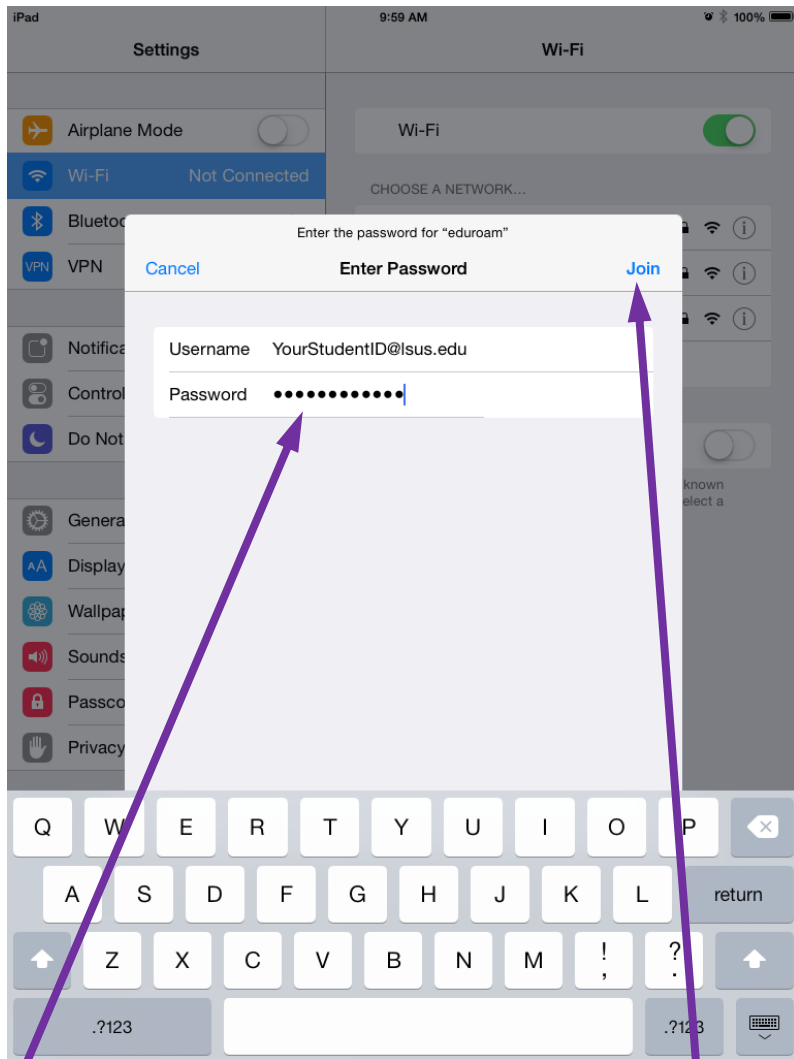

4. Enter your information as follows:
 - Username: YourStudentID@lsus.edu
 - Password: YourPassword
5. Tap "Join."

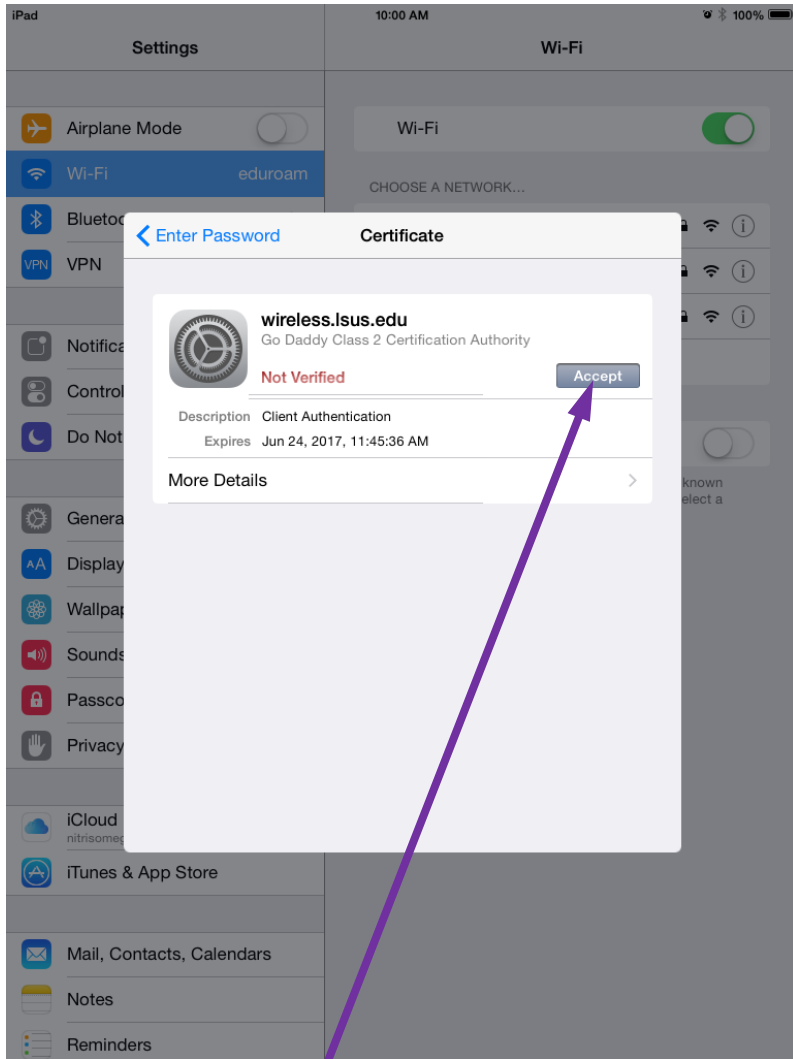

6. Tap "Accept."



At this point the device should be on eduroam wireless.